

Box1,2,4 Controller Cabinetry

Feb 2014



Box1, Box2, Box4 shown with walnut sides and blank panels

Box-style cabinets are low-profile for holding controller modules and other synthesizer modules. Available in 1,2 and 4 spaces. Box1,2,4 cabinets may be mounted to a QKB keyboard controller or used stand-alone, even on the floor as a foot-operated component.

Power Box1,2,4 cabinets with our desktop QPS4 power supply, QPS5 power supply, or from a synthesizer cabinet using our QIC cabinet interconnect cables. Box1,2,4 provides two power connectors to allow daisy-chaining with other controllers and cabinets.

Part numbers

QCB1	Box1 Cabinet with internal power harness (no sides or power supply)
QCB2	Box2 Cabinet with internal power harness (no sides or power supply)
QCB4	Box4 Cabinet with internal power harness (no sides or power supply)
QCKB-SS-W	Sides, straight, walnut (each)

Specifications

External Connectors: 2) 6-pin Female DC power connectors.

Width: Box1=2.125", Box2=4.25", Box4=8.50"

Length: 8.75"

Depth Inside behind panel: 2.375"

Synthesizers.com



Box1,2,4 Controller Cabinetry

Feb 2014

Box1,2,4 cabinets can be mounted directly to keyboard controllers, to each other, or can be used stand-alone. QKB keyboard controllers provide mounting points for Box1 on the back also. Here are some ideas:



Power Connections

Box1,2,4 cabinets have two power connectors wired together and wired to the internal module power harness. The PWR IN connector receives power from a power supply, another cabinet, or from a keyboard. PWR OUT sends power to the next cabinet. Use our QIC cabinet interconnect cables to make the connection.

Never connect two separate power supplies together.



Edge Clearance

Side brackets of Box1,2,4 cabinets are flush with the side of the module resulting in 1/16 inch less internal clearance than most other cabinets. Modules fit tightly. Be careful not to scrape module components or wires on the brackets when inserting modules from above. It's best to remove the side bracket, slide the module in from the side, then attach the bracket last.

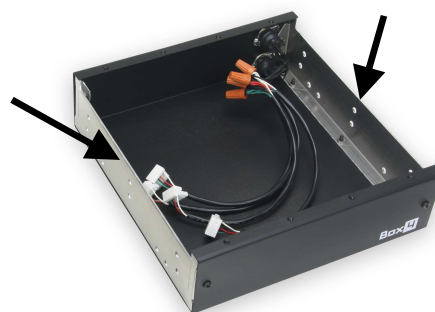

Mounting Side Panels

The following pages provide full-scale mounting-hole templates to attach Box1,2,4's side brackets to side panels. These templates also provide hole patterns for attaching QKB keyboard controllers to the side panels.

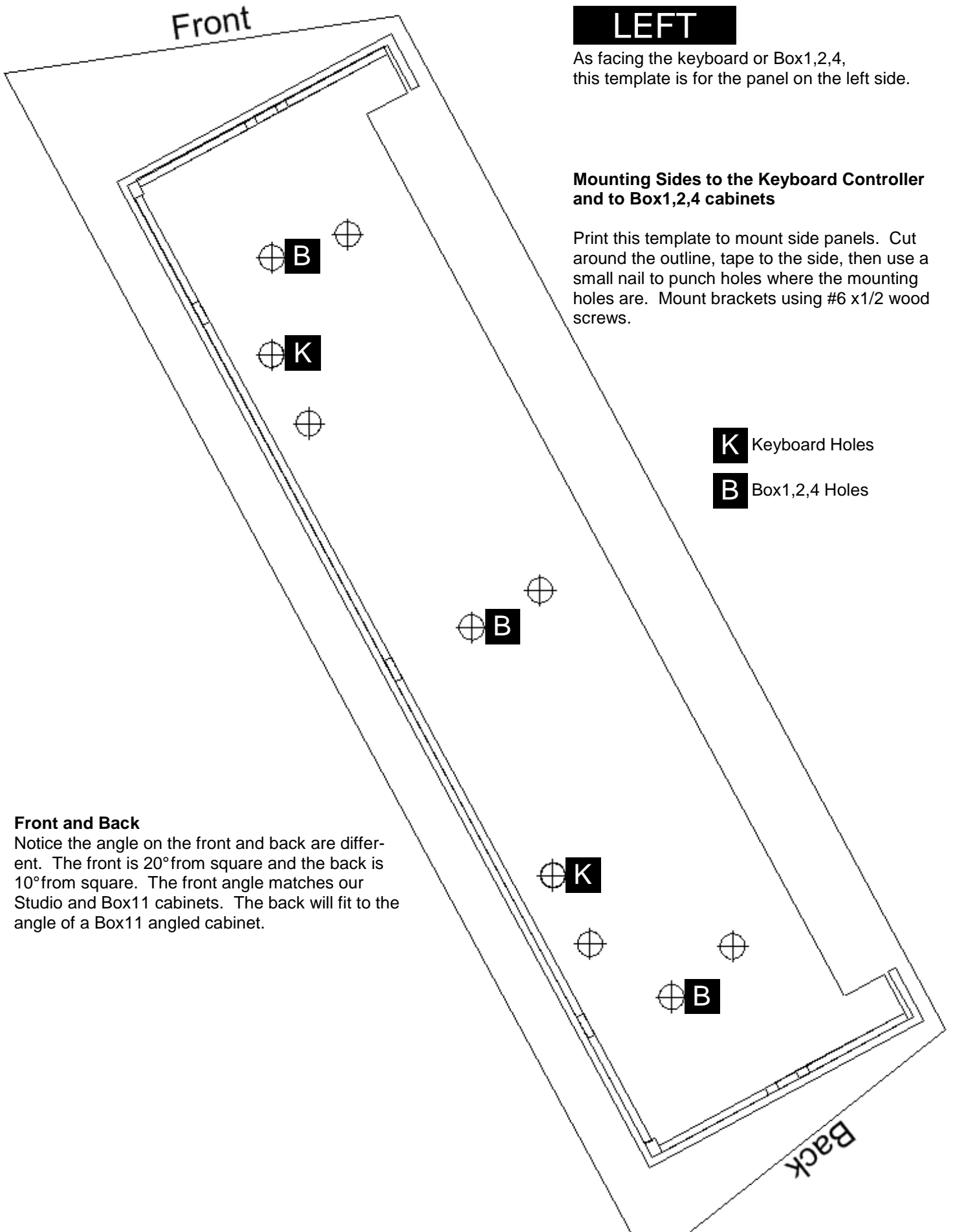

LEFT

As facing the keyboard or Box1,2,4, this template is for the panel on the left side.

Mounting Sides to the Keyboard Controller and to Box1,2,4 cabinets

Print this template to mount side panels. Cut around the outline, tape to the side, then use a small nail to punch holes where the mounting holes are. Mount brackets using #6 x1/2 wood screws.

- K** Keyboard Holes
- B** Box1,2,4 Holes

Front and Back
 Notice the angle on the front and back are different. The front is 20° from square and the back is 10° from square. The front angle matches our Studio and Box11 cabinets. The back will fit to the angle of a Box11 angled cabinet.

This page is mostly blank

RIGHT

As facing the keyboard or Box1,2,4, this template is for the panel on the right side.

Mounting Sides to the Keyboard Controller and to Box1,2,4 cabinets

Print this template to mount side panels. Cut around the outline, tape to the side, then use a small nail to punch holes where the mounting holes are. Mount brackets using #6 x1/2 wood screws.

B Box1,2,4 Holes

K Keyboard Holes

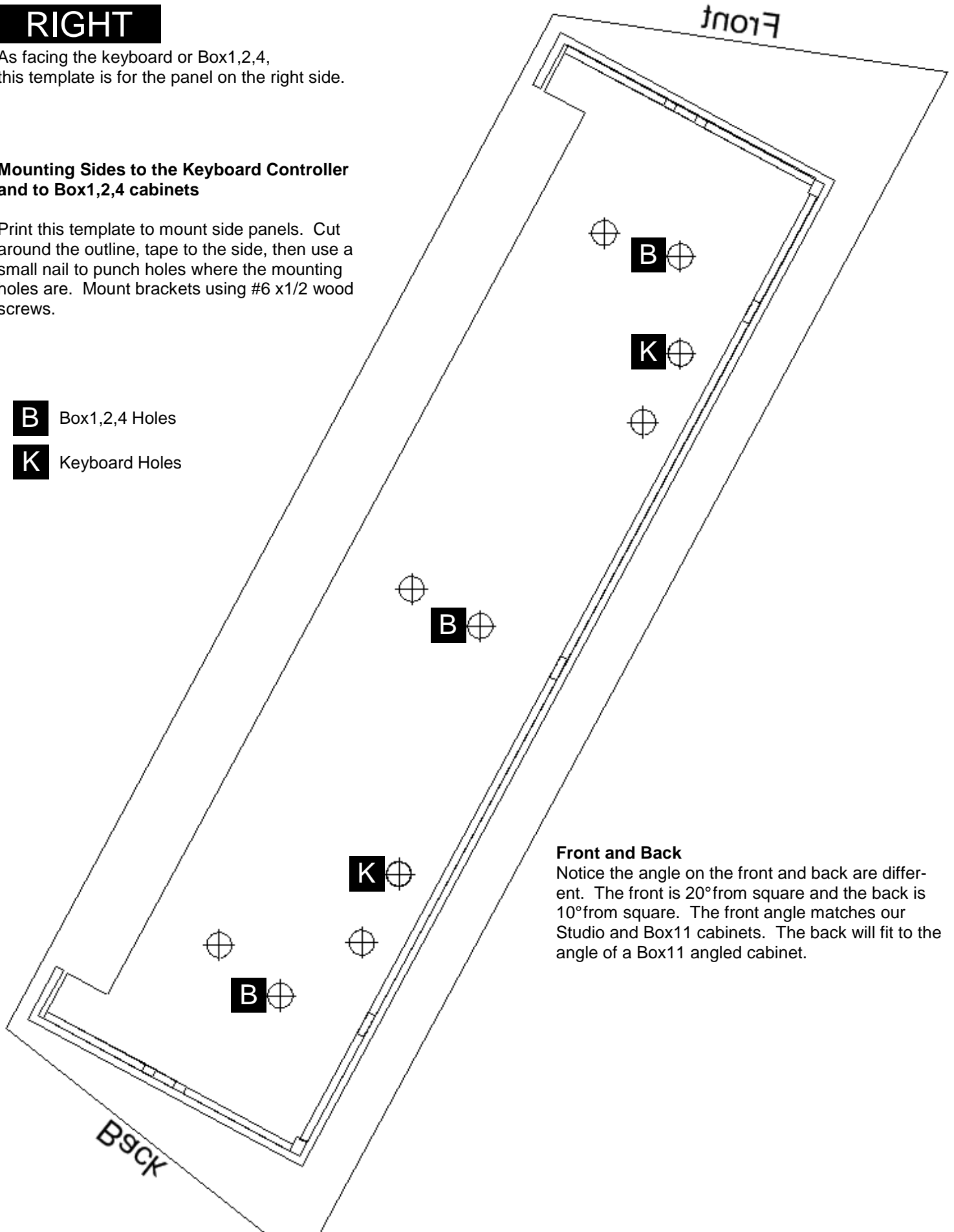

Front and Back

Notice the angle on the front and back are different. The front is 20° from square and the back is 10° from square. The front angle matches our Studio and Box11 cabinets. The back will fit to the angle of a Box11 angled cabinet.

This page is mostly blank